



**QUESTION 3: PERSPECTIVE**

**Given:**

A plan and elevations of a house, as well as the Picture Plane (PP), Horizon Line (HL), Ground Line (GL) and Station Point (SP).

**Instructions:**

- Determine the vanishing points and label them.
- Draw a two point perspective view of the house.
- The indicated door and windows must be shown.

**Notes:**

No hidden detail must be shown.  
Show all the construction lines.

[20]

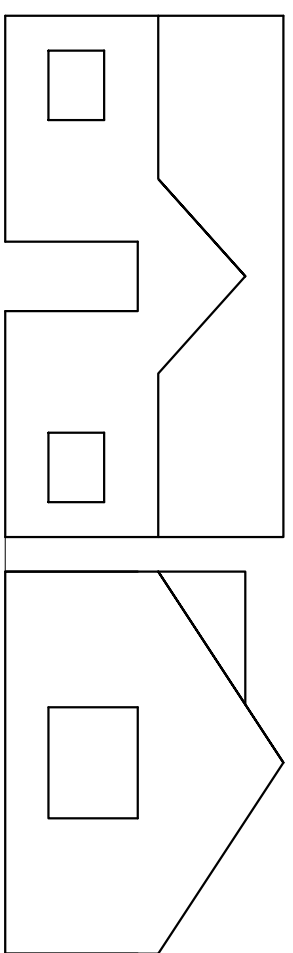
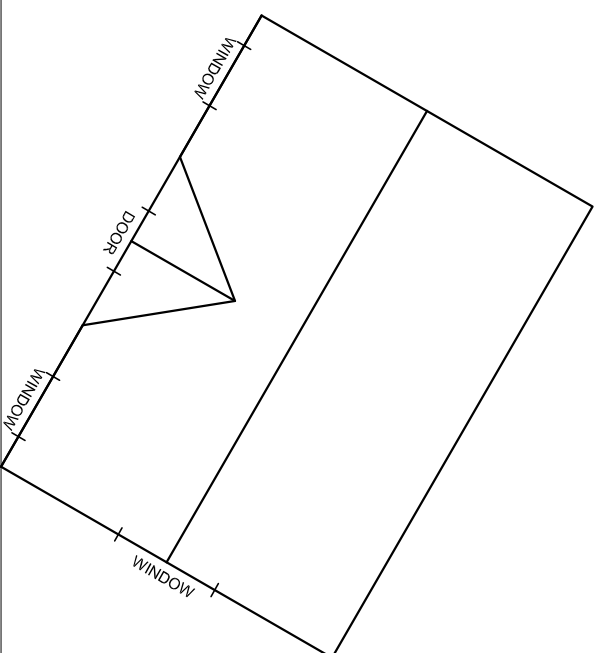

GL

PP / PV

HL

ASSESSMENT CRITERIA	
Vanishing points	4
Roof (10÷2)	5
Walls (6÷2)	3
Door & windows (16÷2)	8
<b>TOTAL</b>	<b>20</b>

NAME	
NAME	
NAME	

4