



**QUESTION 3: ISOMETRIC DRAWING**

**Given:**

The front view and left view of a pipe support.  
The position of point A on the drawing sheet.

**Instructions:**

3. Convert the orthographic views of the pipe support into an isometric drawing.

- Make corner A the lowest point of the drawing.
  - Show ALL necessary construction.
  - NO hidden detail is required.
- [43]**

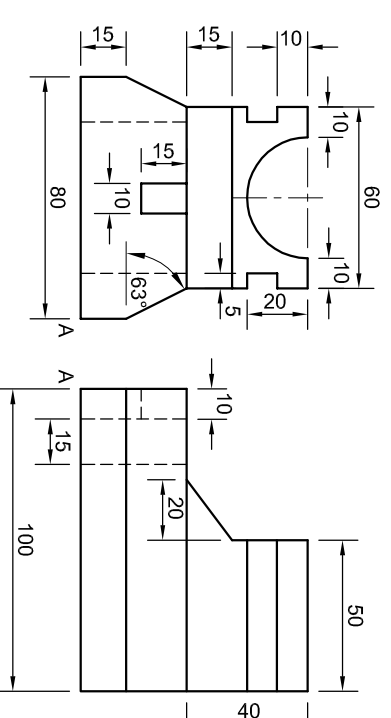

**ASSESSMENT CRITERIA**

AUXILIARY VIEW/	=	2
ISOMETRIC LINES	=	26
NON-ISOMETRIC LINES	=	5
ISOMETRIC CIRCLES	=	3
CIRCLE CONSTRUCTION	=	3
CENTRE LINES	=	3
PLACING ON A	=	1
<b>TOTAL</b>	<b>=</b>	<b>43</b>



EXAMINATION NUMBER	
EXAMINATION NUMBER	<b>4</b>